



**10 YEAR**  
Guarantee  
Against  
Atmospheric  
Conditions



**JUNNARIT.PVC**  
**ROOF PANELS**

E-Mail: [M.d@ahm-pc.com](mailto:M.d@ahm-pc.com)  
Tele fax: 002 375 275 21

Website: [www.ahm-pc.com](http://www.ahm-pc.com)  
CellPhone: 002 01122334488

& 01156141111

Address: (155 El-maryoteia St, - El-haram - Giza-Egypt. )Al-Andalus building - 1st floor





1000 x 450 x 150 mm  
Top Ridge Unit  
Tepe Mahya

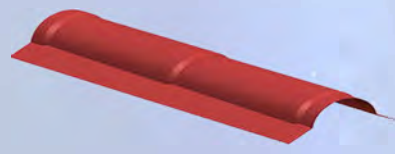

860 x 280 x 90 mm  
Diagonal Hip Ridge  
Diyagonal Oluk Mahya

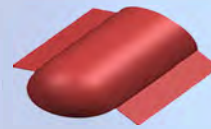

300 x 250 x 100 mm  
Terminal Diagonal Ridge  
Oluk Mahya Bitim Kapağı



600 x 280 x 100 mm  
3 Way Ridge  
3 Yollu Mahya

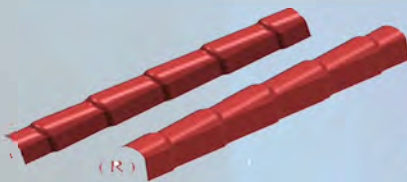

1000 x 139 mm  
Side Ending Unit (E-R)  
Kenar Bitim Mahya (Sol Sağ)

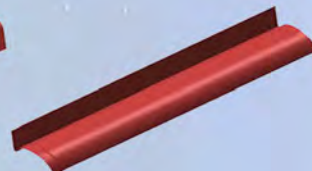

1000 x 150 x 185 mm  
Side Wall Ridge  
Düvar Kenar Mahya



1000 x 220 x 150 mm  
Wall Flashing Ridge  
Düvar Bitim Mahya

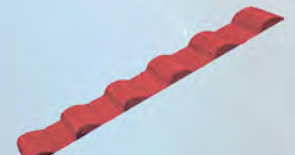

1000 x 450 x 150 mm  
Eave Closing Ridge  
Saçak Kapama Mahya



***JUNNARIT.PVC***



***JUNNARIT. PVC***

# ***JUNNARIT. PVC*** **ROOF PANELS**



*"INSTALL IT ONCE,  
FORGET IT FOR A LIFE TIME"*

**Contact Us**



**Roofing , Cladding & Insulation systems**

**WWW.ahm-pc.COM**

**E-Mail: M.d@ahm-pc.com**

**Tele fax: 002 375 275 21**

**Website: www.ahm-pc.com**

**CellPhone: 002 01122334488**

**& 01156141111**

**Address:(155 El-maryoteia St, – El-haram - Giza-Egypt. )Al-Andalus  
building – 1st floor**

# JUNNARIT.PVC

## ROOF PANELS

### Technical Specs.



#### Dimensions

Width	Effective Width	Thickness
105 cm	95 cm	2.5 mm
Weight	Lenght	Height
4,75 kg/m <sup>2</sup> (+/-%5)	2 m 2,5 m 3 m	30 mm



\* Junnarit panels can be produced in desired lengths up to 12 meters.



#### Test Results

Density (TS EN ISO 1183-1)	Operating Temperature (TS EN ISO 306)	Load Capacity
1,45 g/cm <sup>3</sup>	-40°C +94°C	200 kg/m <sup>2</sup>
Water Absorption Ratio (ISO 62)	Thermal Conductivity Resistance (ISO 62)	Color Deviation (TS 10883)
%0,02	0,18 m <sup>2</sup> k/w	DE*0,2
Impact Strength (TS EN ISO 180/1A)	Tensile Strength (TS EN 527-2)	Flammability (TS EN 13501-1)
489 kgf/cm <sup>2</sup>	477 kgf/cm <sup>2</sup>	B

#### Color Options

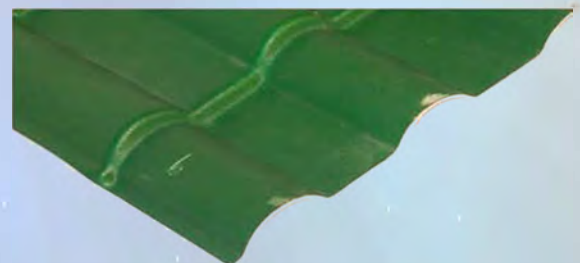
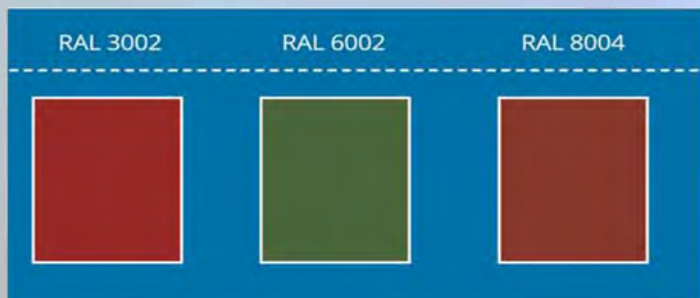

E-Mail: [M.d@ahm-pc.com](mailto:M.d@ahm-pc.com)

Tele fax: 002 375 275 21

Website: [www.ahm-pc.com](http://www.ahm-pc.com)

CellPhone: 002 01122334488

& 01156141111

Address:(155 El-maryoteia St, - El-haram - Giza-Egypt. )Al-Andalus building - 1st floor



# JUNNARIT.PVC

## ROOF PANELS

### Advantages of Junnarit Synthhetch resin roof tiles



It is not affected by atmospheric conditions. It is compatible with all climates.



It is durable against impacts. It does not crack.



It is durable from -40 °C to +100 °C.



It preserves its colour and shape for 30 years.



It is fireproof and nonflammable.



It brings insulation quality to buildings.



It has different color options.



It is hygenic, dust and dirt proof.

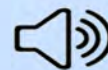

It has excellent sound and air isolation.



It protects buildings against water and humidity.



It is nondeformable in asidic environment. It is noncorrodible.



It is easy to transport and install.



It is 10 times lighter than clay tile.

	pvc/Junnarit Roof Tile	PMMA Roof Tile	Clay Tile
Mass of m <sup>2</sup> tile	4,75 kg	5 kg	45 kg
m <sup>2</sup> Capacity per 20' container	5050 m <sup>2</sup>	4600 m <sup>2</sup>	550 m <sup>2</sup>
Operating Temperature	-40 °C +94 °C	-40 °C +70 °C	-40 °C
Fire Class	B	B	A
Water Absorption Ratio	%0,02	%0,08	%10
Thermal Conductivity Resistance	0,18 m <sup>2</sup> k/w	0,20m <sup>2</sup> k/w	0,03m <sup>2</sup> k/w
Load Capacity	600 kg	150 kg	150 kg



## Product Specifications

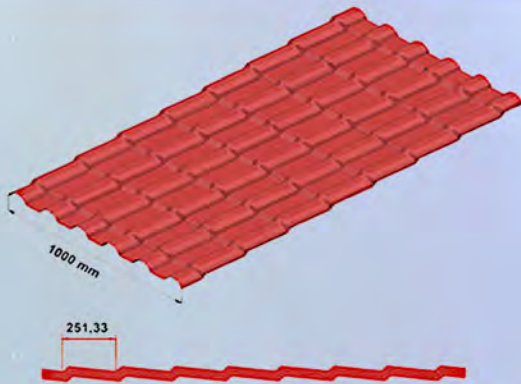

Width mm	Effective width, mm	Pitch N/O	Thickness mm	Height mm	Wave Length mm	Weight Kg/m <sup>2</sup>
1000	900	6	3	39	U*251.33	4.6

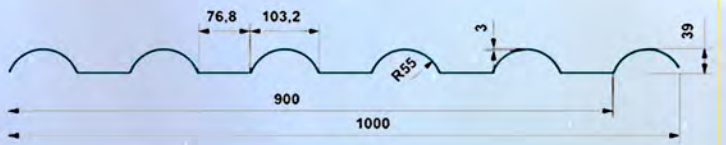

## Assembly Drawing

## Accessories and Fittings



## Required Working Tools

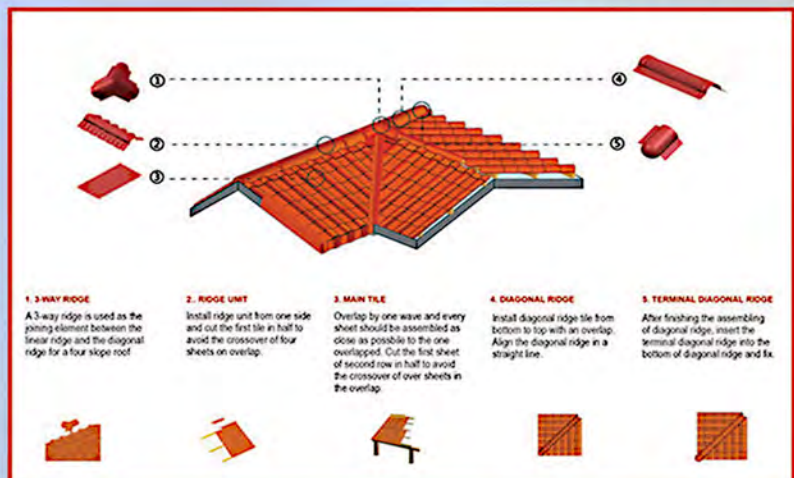

**JUNNARIT.PVC**